



1a Bakers Lane, Sandy, SG19 2BJ

£350,000

Located in Tempsford village is this detached, two doubled bedroom cottage, with a garage and off road parking.

Step inside an entrance hall with space to hang coats, and understairs storage. Through to a bright and welcoming lounge and dining room, which offers dual aspect views to the front and back. At the heart of the room is an open fireplace with brick surround, creating the perfect focal point for cosy evenings as the seasons change. Newly installed French doors open directly onto the garden, allowing plenty of natural light to flow through and seamlessly connecting the indoor and outdoor spaces.

The kitchen offers a classic cottage feel with pine-fronted cabinetry and space for an oven, washing machine and fridge freezer. A large pantry provides excellent additional storage, whilst the garage can also be accessed directly from the kitchen.

Floor Plan

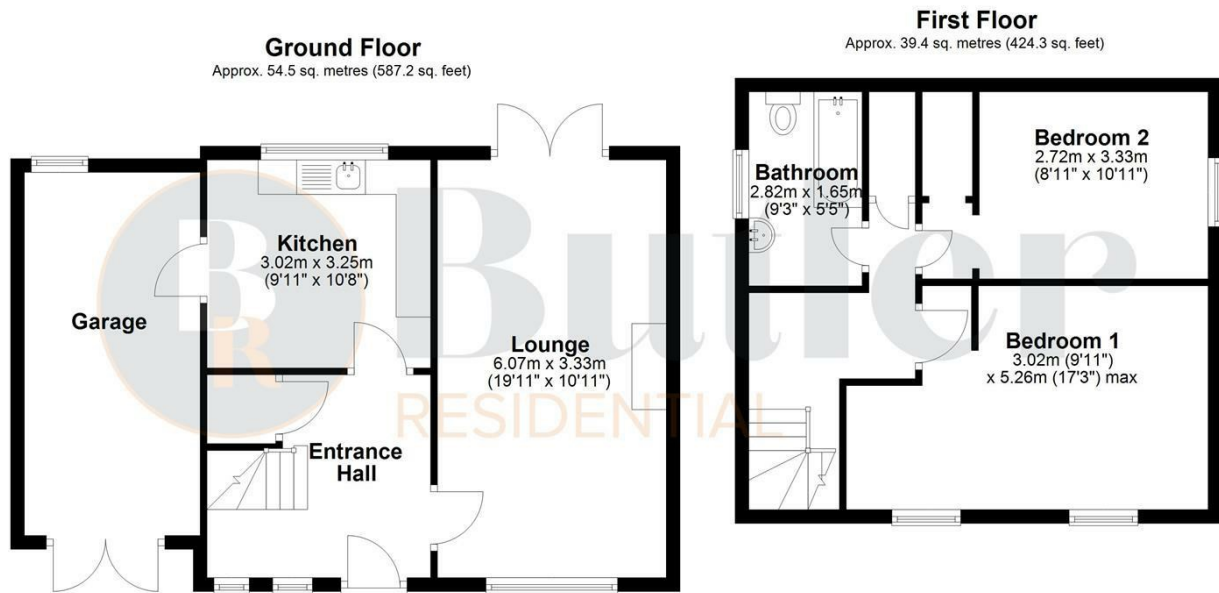

Total area: approx. 94.0 sq. metres (1011.4 sq. feet)

Area Map



Energy Efficiency Graph

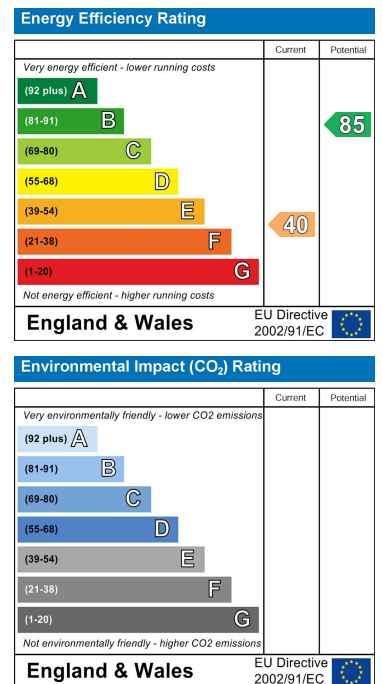

These particulars, whilst believed to be accurate are set out as a general outline only for guidance and do not constitute any part of an offer or contract. Intending purchasers should not rely on them as statements of representation of fact, but must satisfy themselves by inspection or otherwise as to their accuracy. No person in this firm's employment has the authority to make or give any representation or warranty in respect of the property.